

USER MANUAL



PATV85

BLUETOOTH® | ALL-TERRAIN SOUND SYSTEM
FEATURING LED ILLUMINATION
AND 8" MARINE SPEAKERS
AND 1.5" WEATHERPROOF
TWEETERS



Planet Audio®

Thank you for purchasing this



PATV85 All-Terrain Sound System

Please read through these instructions carefully so you will know how to operate your model properly.

After you have finished reading the instructions, keep this document in a safe place for future reference.

THIS PACKAGE CONTAINS

1x All-terrain sound system (with a 12V power port plug)

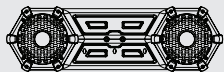

Controller mounting kit



4x Sound system mounting straps



1x 12V power port plug adapter



1x Functional controller



1x User manual + 1x Warranty card



The Bluetooth® word mark and logos are registered trademarks owned by Bluetooth SIG, Inc. and any use of such marks by Planet Audio is under license. Other trademarks and trade names are those of their respective owners.

Read and understand all instructions before you use your product. If you do not follow the instructions in this manual, we are not responsible for injury or damage resulting from improper handling. This will also void the warranty.

Important Safety Precautions

- **Be sure to observe the following guidelines:**
 - Do not increase speaker volume so high that you cannot hear what is around you.
 - Use caution or temporarily discontinue use in potentially hazardous situations.
- Do not make any adjustment on the product when driving or in other situations where distractions can be hazardous. Responsible and safe driving is your primary responsibility when operating a vehicle.
- Start volume at a low setting then gradually increase the volume until you can hear it comfortably, without sound distortion and ear discomfort.
- In the event of smoke, strange noise or odor emitted from the product or any other abnormal operational signs appearing on the product, disconnect the product from the power supply. Discontinue use and contact your dealer or our technical support. Using the product in this condition may result in permanent damage to the system.
- Servicing must only be carried out by a technician. Contact our technical support for any service questions.

Installation Precautions

- **WARNING: Always consult a professional installer.**
- Installation must be performed by a professional. Contact our technical support for any installation questions.
- Observe the safety and operating instructions of the devices which are connected to the product.
- Only use attachments/accessories specified by the manufacturer for installation.
- Do not modify this product, as this affects the safety of the product and creates a risk of injury.
- Before installation, disconnect the negative terminal of the vehicle battery to prevent damage to the product, fire, and/or possible injury.

Care for Your Product

- **DO NOT** clean the product in hot weather (e.g. hot sunlight).
- **DO NOT** use abrasive or highly alkaline cleaner on the product.
- **DO NOT** use gasoline, acetone, carbon tetrachloride or other aggressive chemical solutions on the product.
- **DO NOT** scrape the product with razor blade or other sharp instrument.
- This product is weatherproof. However, never submerge the product in water.
- Wash the product with lukewarm water and mild soap or detergent, using a clean sponge or soft cloth. Rinse well with clean water.

Introduction

The product is a Bluetooth speaker system which is ideal for installation in a ATV (All Terrain Vehicle) or UTV (Utility Vehicle). You can stream audio from a mobile phone to this product via Bluetooth. You can also play music from an external device (e.g. a mobile phone or MP3 player) via 3.5 mm AUX input jack.

You can charge your mobile phone using the built-in USB port (1A, not for media playback) which is located inside the large front storage compartment. A LED light bar is also equipped.

This product is shockproof and weatherproof. This product is operated with 12 VDC vehicle power supply. Never connect this product to any other voltage supply (e.g. 24 VDC).

Product Overview

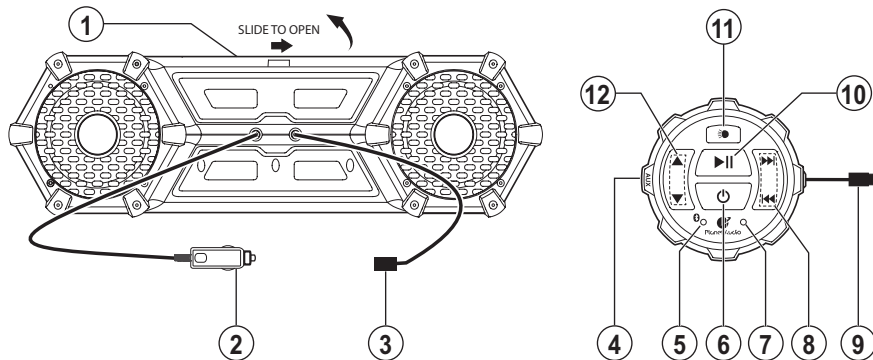

Main Unit

- 1 Storage compartment with USB charging port inside
- 2 12V power port plug with 10A fuse
- 3 Functional controller jack

Functional Controller

- 4 3.5mm audio input jack
- 5 Bluetooth connection LED indicator

- 6 Power button
- 7 Source LED indicator
(Red=AUX input source/ Blue=Bluetooth source)
- 8 Track selection buttons
- 9 Functional controller plug
- 10 Start/pause/resume play button
- 11 On/Off button for LED light bar
- 12 Volume buttons

Mounting on ATV or UTV



Always consult an expert when in doubt about the installation.

Use only the supplied accessory for mounting. Using other mounting methods may void the warranty.

To ensure safety of the mounted sound system, always check the mounting conditions (e.g. mounting straps) of the sound system before each vehicle ride.

1. Using four supplied mounting straps, secure the sound system on the rails or roll bars of your vehicle, as shown in the figure below. Make sure the sound system is securely attached to your vehicle.



No special tool is required when mounting the sound system on ATV or UTV.

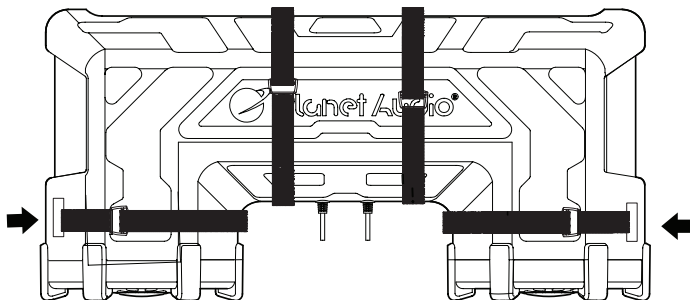

Option 1: Using Power Port

If your vehicle has a 12V power port, directly connect the sound system to your vehicle for power connection.

1. Connect the supplied functional controller: Align the arrows marked on the connectors for connection.
2. Insert the 12V power port plug of the sound system into your vehicle power port. When the power supply is connected, the power LED indicator illuminates on the power port plug.

Note: To avoid battery drain, unplug the power port cable after each use (if the port power is not switched off with the ignition key).

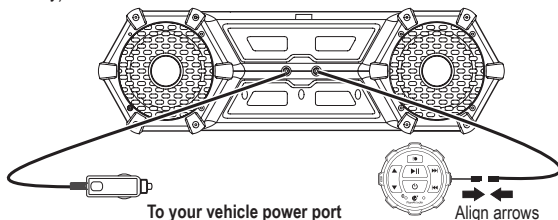

Option 2: Using Power Port Plug Adapter

If your vehicle does not have a 12V power port, use the supplied power port plug adapter for connection to your vehicle battery.

Important:

- To avoid short circuits and any resulting damage to the sound system, the negative terminal of the vehicle's battery must be disconnected first.
1. Connect the supplied functional controller: Align the arrows marked on the connectors for connection.
 2. Connect the black/ground wire of the power port plug adapter to the vehicle's metal frame or to the negative battery terminal. Fasten the ground wire with a bolt/screw on the metal surface. Make sure the metal surface is clean with no paint, rust or dirt.
 3. Connect the red wire of the power port plug adapter to the positive battery terminal.
If needed, use extension wires of 12-14 gauge for connection to the battery. **Remember to install a 15A in-line fuse (not included) and an on-off switch (not included).** An on/off switch is not needed if you unplug the power port cable after each use or if the vehicle power port is turned off with the ignition key. Refer to the illustration.
 4. Insert the power port plug of the sound system into the power port plug adapter.
When the power supply is connected, the power LED indicator illuminates on the power port plug.

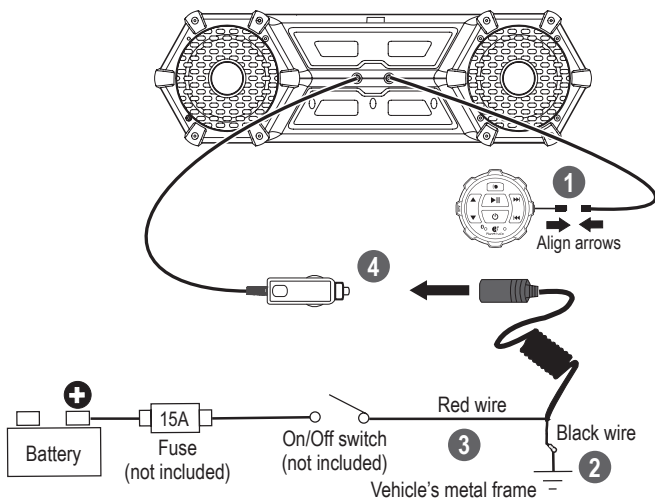

Option 3: Direct connection to vehicle battery

Important:

- To avoid short circuits and any resulting damage to the sound system, the negative terminal of the vehicle's battery must be disconnected first.
1. Remove the plug from the supplied power port plug cable.
 2. Connect the power port plug's negative wire to the vehicle's metal frame or to the negative battery terminal, and the power port plug's positive wire to the positive battery terminal.
- To prevent electrical damage, you must install **1) a 15A fuse (not included)** and **2) an on/off switch (not included)** to be in line with the power wire which connects to the positive battery terminal.
 - Fasten the ground wire with a bolt/screw on the metal surface. Make sure the metal surface is clean with no paint, rust or dirt.

Turn on or off

- Press and hold  on the functional controller to turn on or off the sound system.



To avoid battery drain when the sound system is not used, disconnect the sound system from the battery by unplugging the power port cable or using the inline on/off switch (not included).

Note: The supplied functional controller is weatherproof. However, never submerge it.

Option 1: Surface Mount

You may use double sided adhesive tape (not included) to fasten the supplied functional controller. Regularly check the taped controller to ensure its fastening.

Option 2: Handlebar Mount

1. Assemble and fasten the mounting clamp on your handlebar.
 - Use the supplied clamp, brackets, bolts, nuts and washer and rubber strips for assembly and fastening.
 - Place the supplied rubber strip on the inner side of the clamp to provide more secure fastening.
2. Secure the functional controller: snap the functional controller onto the snap bracket of the clamp via the slot on the back of the functional controller.

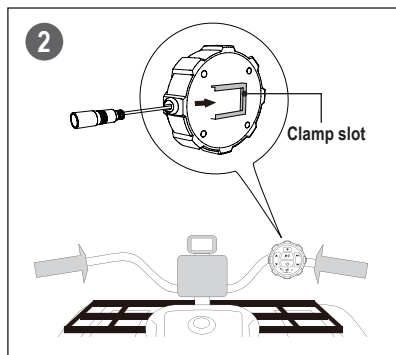
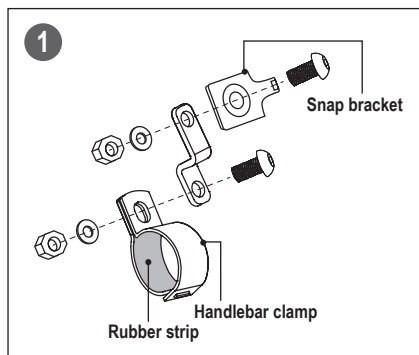

Before you can stream music from your mobile device (iOS device or Android device) to this sound system through Bluetooth, pair the sound system with your mobile device.

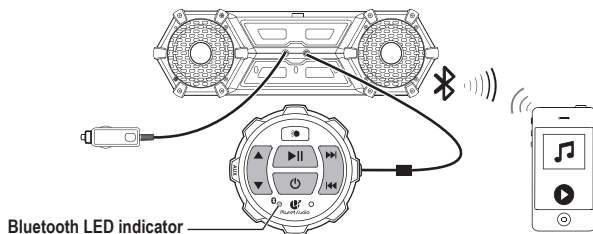

1. Make sure the AUX cable is not connected to the sound system. Press and hold  on the functional controller to turn on the unit.
The Bluetooth LED indicator on the functional controller flashes blue. This indicates that the sound system enters Bluetooth pairing mode.
2. On your mobile device, enable Bluetooth function and select the device name ("Planet Audio ATV") to pair the sound system with the mobile device. If prompted for password, input "0000".
Note: Only one device can be paired at a time.
3. When successfully paired/connected, The Bluetooth LED indicator turns to solid blue from flash.

Play audio on your mobile device, and audio will be streamed to the sound system. Use the volume control on the connected device to adjust volume.





After pairing, the sound system will automatically connect to your mobile device each time the two are both turned on. To change Bluetooth source, disconnect the current Bluetooth connection then repeat the steps above to connect/pair with another mobile device.

➡ To maximize audio performance, set the volume of the connected device to a minimum of 75%. Ideally, on the highest volume setting you can get without distortion.

To avoid battery exhaustion, be sure to run the vehicle engine when operating the sound system. Operational range can be reduced by any obstacle between the sound system and the device.

If the connected device is out of the effective range from the sound system, the device will be automatically disconnected. The device will be automatically re-connected if it is back to the range.

Playback control

- To pause or resume play, press .
- To select the previous or next track, press  or .
- To adjust volume, press  / .

You can listen to an external audio device (e.g. MP3 player or a mobile phone) through this sound system.

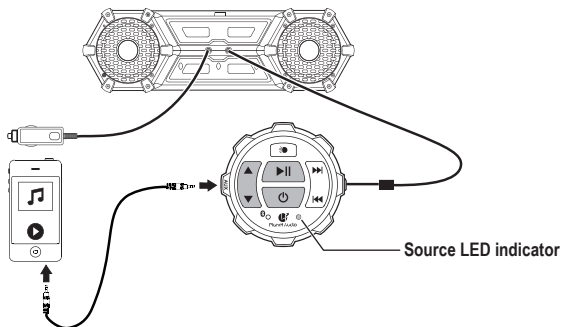

1. Connect the AUX input (3.5mm) on the functional controller to the audio output jack on your mobile phone, using the following audio cable.

- For a mobile phone with 3.5mm headphone jack, use the 3.5mm audio cable (not included).
- For a mobile phone with USB-C port, use USB-C to 3.5mm cable (not included).
- For an iPhone with lightning connector, use lightning to 3.5mm cable (not included).

The sound system automatically switches to AUX input source. The source LED indicator on the functional controller turns to red.

2. Select and play audio files on your audio device. Audio from the connected device will be played on this sound system.

➡ To maximize audio performance, set the volume of the connected device to a minimum of 75%. Ideally, on the highest volume setting you can get without distortion.

To resume Bluetooth connection, you must disconnect the AUX cable from the sound system.

Operating the sound system consumes the vehicle battery. To avoid battery exhaustion, be sure to run the vehicle engine when operating the sound system.

Playback control

- To mute or un-mute volume, press ►||.
- To adjust volume, press ▲/▼.
- To select the previous or next track, use the controls only on the connected device.

Fuse replacement of the vehicle power port plug

If the power LED indicator on the power port plug does not illuminate, this indicates the fuse inside the power port plug is blown. Replace the blown fuse with a new 10A AGC fuse (glass cartridge type).

1. Locate the screw cap on the front end of the power port plug. Turn counterclockwise the screw cap to open then access the fuse inside.
2. Replace with a new fuse (not included). Then replace the power port plug while ensuring the contact head sticks out.

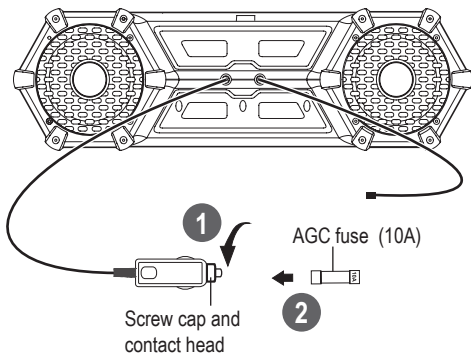

USB Charging

Open the front storage compartment to access the USB charging port (1A) to charge your mobile devices.

The USB port is for charging only, not for media playback.

LED Light Bar

The sound system is equipped with a LED light bar on the front.

You can press  on the functional controller to turn on or off the light bar.

If you have problems using this product, check the following points before you request service. If you still have a problem, contact our technical support.

Problem	Solution
No power.	Power connection is not made. See the section "Power Connection" for details.
	The ACC switch of the vehicle is not on. Turn the ACC switch on.
	The fuse inside the power port plug is blown. Replace the fuse.
No sound.	Check the connected device for volume level or playback status (e.g. pause or stop).
Cannot connect through Bluetooth.	Make sure the AUX cable is not connected to the sound system.
	The device is not paired with the sound system. Pair the two (see "Bluetooth" section).
	Make sure the device is within range.
	The sound system is already connected with another Bluetooth device. Disconnect the current Bluetooth connection.
Audio quality from Bluetooth connection is poor.	Move the device closer to the sound system or remove obstacles or sources of interference that are affecting Bluetooth reception.
No response.	Power glitch or interference. Disconnect power for ten seconds then reconnect power.

Care of the Environment

Do not throw away the product with normal household waste at the end of its life. Follow your local laws if/when disposing of electronic products. By doing this, you help preserve the environment.

Bluetooth

Bluetooth version.....	3.0 / EDR
Bluetooth profile.....	A2DP, AVRCP
Transmission distance	up to 33 ft / 10 m (line of sight)

Speakers

Dimensions.....	8"
Cone type	PP carbon + rubber surround
Tweeter size	1.5" PEI soft dome

Amplifier

Input impedance.....	10 k Ω
Frequency response.....	45 Hz - 25 kHz

LED Light Bar

Current draw.....	3A total
LED color.....	7000K
Beam pattern.....	Spot/Flood combo

General

Input voltage/current.....	12 VDC (allowable 10 - 16 VDC)
Current draw	9.7A max.
USB charging	1A max.
Fuse.....	10A AGC type
Weight	20.5 lbs / 9.31 kg

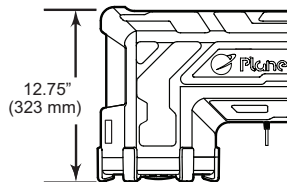
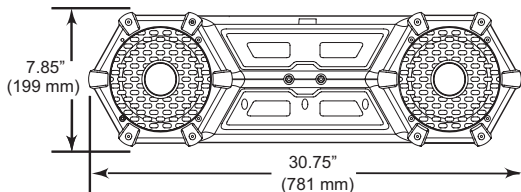
Dimensions drawings



USER MANUAL

PATV85

BLUETOOTH® | ALL-TERRAIN SOUND SYSTEM

www.planetaudio.com

TELEPHONE

805-751-4854 Customer Service

TECHNICAL SUPPORT

www.planetaudio.com/support



0324