

# USER MANUAL

## QUICK INSTALLATION GUIDE



Planet Audio

PGR35B

FEATURING ZERO  
STANDBY CURRENT DRAIN

# USER MANUAL

## QUICK INSTALLATION GUIDE

PGR35B  
BLUETOOTH® GAUGE HOLE RADIO

Planet Audio  
www.planetaudiousa.com

TELEPHONE  
805.988.0215

FAX  
805.988.0275

TECHNICAL SUPPORT  
www.planetaudiousa.com/support

iPod® and iPhone® are registered trademarks of Apple Inc.  
registered in the USA and other countries.  
Planet Audio is not affiliated with Apple Inc.

CE FC  
215 VER:1.0 EN



Thank you for purchasing this



**PGR35B Bluetooth Gauge Hole Radio**  
Please read through these instructions  
carefully so you will know how to operate  
your model properly.

After you have finished reading the instructions,  
keep this document in a safe place  
for future reference.

### THIS PACKAGE CONTAINS

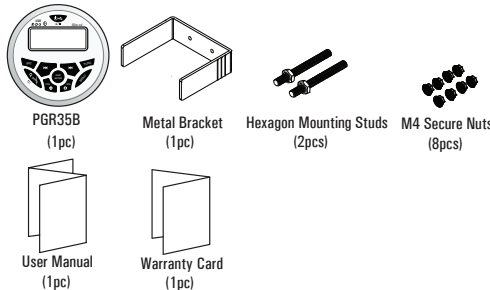

### INFORMATION TO THE USER



The Bluetooth® word mark and logos are registered trademarks  
owned by Bluetooth SIG, Inc. and any use of such marks is under  
license. Other trademarks and trade names are those of their  
respective owners.

### FCC COMPLIANCE STATEMENT

This device complies with part 15 of the FCC Rules. Operation is  
subject to the following two conditions:

- (1) this device may not cause interference, and
- (2) this device must accept any interference, including interference  
that may cause undesired operation of this device.

This transmitter must not be co-located or operated in conjunction  
with any other antenna or transmitter. The Bluetooth antenna cannot  
be removed (or replaced) by user. This equipment complies with  
FCC/ IC radiation exposure limits set forth for an uncontrolled  
environment and meets the FCC radio frequency (RF) Exposure  
Guidelines and RSS-102 of the IC radio frequency (RF) Exposure  
rules. This equipment has very low levels of RF energy that it  
deemed to comply without maximum permissive exposure  
evaluation (MPE). But it is desirable that it should be installed and  
operated keeping the radiator at least 20 cm or more away from  
person's body (excluding extremities: hands, wrists, feet and  
ankles). Alteration or modifications carried out without appropriate  
authorization may invalidate the user's right to operate the  
equipment.

**NOTE:** This equipment has been tested and found to comply with  
the limits for a Class B digital device, pursuant to Part 15 of the FCC  
Rules. These limits are designed to provide reasonable protection  
against harmful interference in a residential installation. This  
equipment generates, uses and can radiate radio frequency energy  
and, if not installed and used in accordance with the instructions,  
may cause harmful interference to radio communications. However,  
there is no guarantee that interference will not occur in a particular  
installation. If this equipment does cause harmful interference to  
radio or television reception, which can be determined by turning  
the equipment off and on, the user is encouraged to try to correct  
the interference by one or more of the following measures:

- Relocate or reorient the receiving antenna.
- Increase the separation between the equipment and receiver.
- Connect the equipment into an outlet on a circuit different from  
that to which the receiver is connected.
- Consult the dealer or an experienced radio/TV technician for help.

### !! WARNING !!

ADJUSTMENT OR ALTERATIONS OF THIS DEVICE MAY  
RESULT IN HAZARDOUS RADIATION EXPOSURE.

1

### IMPORTANT SAFETY PRECAUTIONS

#### BE SURE TO OBSERVE THE FOLLOWING GUIDELINES:

- Do not turn up the volume so high that you can't hear what's  
around you.
- Use caution or temporarily discontinue use in potentially  
hazardous situations.
- Do not operate mobile video equipment while driving a motorized  
vehicle – safe driving and safety consideration of others should  
always be your highest priority.
- Set your volume control at a low setting, then slowly increase the  
sound until you can hear it comfortably without distortion, or ear  
discomfort.
- In the event you should notice smoke, strange noises or odor from  
this product, or any other abnormal signs, immediately turn off the  
power and consult your dealer or the nearest authorized  
**PLANET AUDIO Service Center**. Using this product in this condition  
may result in permanent damage to the system.

2

### SUGGESTED MOUNTING METHODS

- 1 Make the mounting hole size as follows

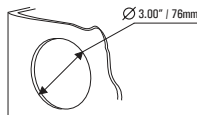

- 2 Install studs mounts into rear of chassis

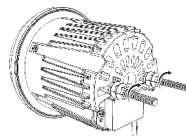

- 3 Adjust M4 nuts for the best mounting depth

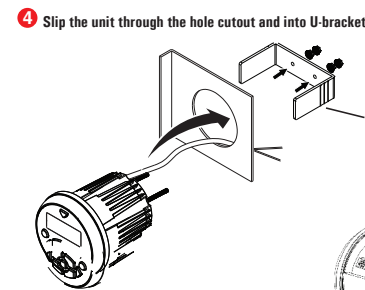

Snap off break-away tabs to best fit  
your applications depth

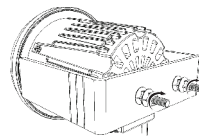

- 6 Secure and waterproof the wiring

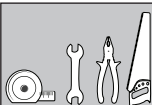

### TOOLS NEEDED:

- Measuring Tape / Ruler
- Wrench and/or Pliers
- Hole Saw
- Crimp Tool

### BEFORE YOU START

### INSTALLATION PRECAUTIONS

#### Always consult with a professional installer

- Do not attempt to install or service this product by yourself.  
Installation or servicing of this product by persons without  
professional training and experience in electronic equipment and mo-  
torized vehicle accessories may be dangerous and could expose you to  
the risk of electric shock, injury or other hazards
- Refer any repairs to a qualified **PLANET AUDIO Service Center**
- The **PGR35B** should be wired directly to a vehicles battery
- When wiring directly to the vehicles battery, be sure to disconnect  
the batteries negative terminal wire before starting any wiring  
procedures, if extending the main power primary wire, it is  
suggested that an optional fuse and fuse holder (not included) with  
minimum rating of 20 Amperes be in-line with the positive battery  
terminal
- The ground cable length should be as short as possible, if  
extending from you battery, be sure to use a proper gauge rating for  
the length of the run, use only high quality copper primary type wire
- The **PGR35B** has a IPX6 weather resistant design, it should not be  
submerged in or under water under any circumstances
- Do not use abrasive cleaning materials on the lens or bezel
- Use only the installation parts provided with the **PGR35B**

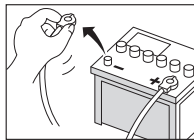

To avoid potential shorts in the electrical  
system, be sure to disconnect the (-)  
battery cable before installation. Use this  
unit with a 12-Volt battery and negative  
grounding only. Failure to do so may result  
in a fire or malfunction.



When replacing the fuse, be sure to only use a  
fuse of the rating specified on this product. To  
avoid short-circuiting, cover any disconnected  
leads with insulating tape. It is specially impor-  
tant to insulate any unused wires, which if left uncovered may cause a  
short circuit. When connecting other devices to this product, refer to  
the manual for the product to be connected. The black cable is ground,  
make sure to connect the ground wire first.

Ensure that the ground cable is properly connected to metal parts of  
the vehicles body frame or direct to the battery if your vehicle does not  
have a grounded chassis frame. The ground cable of this units power  
amp and a second powered system must be connected to the frame  
separately with different screws. If the screw for the ground wire  
loosens or falls out, it could result in fire or malfunction.

3

### WIRE DIAGRAM

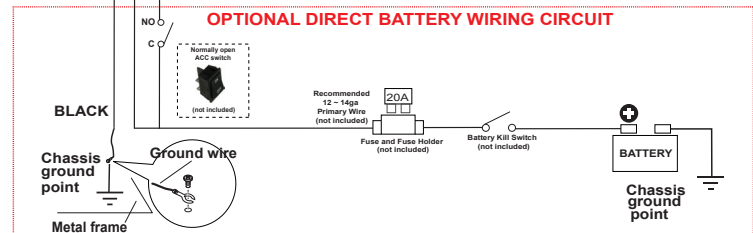
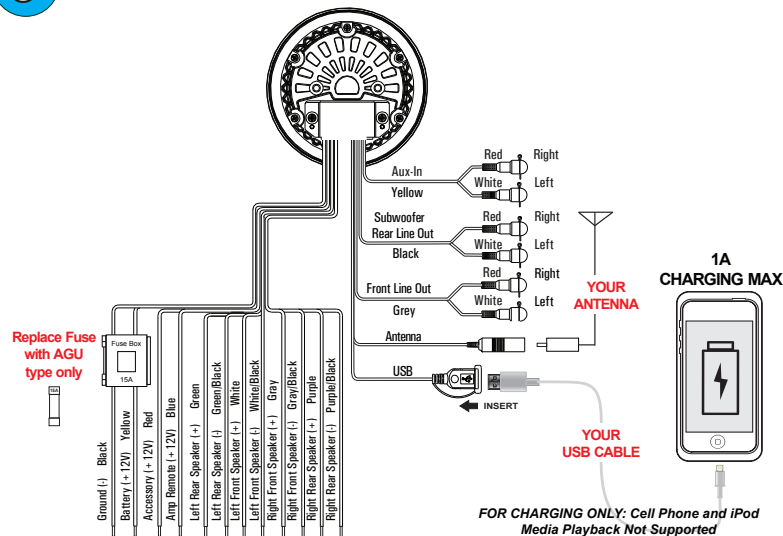

### CAUTION!!

Do not ground or short the speaker leads

### TROUBLE SHOOTING GUIDE

TROUBLE	CAUSE	SOLUTION
Unit will not turn on	The fuse is blown	Check / replace the fuse
	Ignition not engaged	Turn ignition to on position
	Blown speaker	Replace faulty speaker
	Volume is low / muted	Press the volume level up
No sound is heard	Device is paused or muted	Check your devices playing / volume status
	The Bluetooth function of the device is not enabled	Refer to the user manual of the device for how to enable the Bluetooth function
Cannot pair Bluetooth	The PGR35B BT memory is full	Follow how to reconnect a device in section E
		Move the device closer to the audio system or remove any obstacle between the device and the systems antenna
The audio quality is poor after connection with a Bluetooth enabled device	The Bluetooth reception is poor	Disconnect power for 10 seconds to reset
	Power glitch or interference	Charge battery, run the engine to recharge the battery
	Low battery power	Reset the main system
Unit has become unresponsive		Follow steps in section B

### TECHNICAL SUPPORT

1-805-988-0215

www.planetaudiousa.com/support

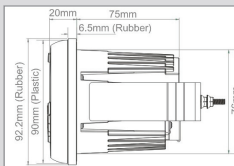

### SPECIFICATIONS

#### FM TUNER FREQUENCY RANGE

- USA 87.5~107.9MHz
- Europe 87.5~108MHz
- Asia 87.5~108MHz
- Australia 87.5~108MHz
- Usable Sensitivity: 12dB (S/N=30dB)
- Bands: 2

#### AM TUNER FREQUENCY RANGE

- USA 530~1710KHz
- Europe 522~1620KHz
- Asia 522~1620KHz
- Australia 522~1620KHz
- Usable Sensitivity: 40dB (S/N=20dB)
- Bands: 1

#### WEATHER BAND SELECTION

- CH.1 162.400MHz
- CH.2 162.425MHz
- CH.3 162.450MHz
- CH.4 162.475MHz
- CH.5 162.500MHz
- CH.6 162.525MHz
- CH.7 162.550MHz
- Bands: 1

#### BLUETOOTH

- BT: 3.0
- BT Range: 33Ft / 10M (Class 2)
- BT Profiles: A2DP / AVRCP 1.3

#### USB DRIVE MEDIA SUPPORTED

- MP3
- WMA
- 65,000 Songs
- 32GB / FAT 32
- USB 2.0 High Speed
- USB Output Voltage: 5VDC @ 1A

#### INTEGRATED AMPLIFIER

- MOSFET
- MAX Continuous Output: 240W (All channels driven)
- PEAK Power Rating: 60W / channel
- RMS Total Power Output: 80W
- Channels: 4
- Class: AB
- Frequency Response: 20-20kHz
- 4Ω stable

#### CHASSIS

- Button Backlight Illumination: BLUE LED
- F/R/S RCA Preamp Output: 2VRMS
- RCA Input Impedance: 10kΩ
- LCD: TN Type / Active Matrix

#### GENERAL

- Power Source: 14.4VDC (10.8V ~ 16V allowable)
- Grounding System: Negative type
- Maximum Current Consumption: 15A
- 3-way protection circuitry (thermal, overload, and speaker short protection)
- Unit Weight: 1.08lbs / 0.52kg
- Storage Temperature: -22°F to 176°F / -30°C to 80°C
- Operation Temperature: -4°F to 158°F / -20°C to 70°C
- Replacement Fuse: 15A

(Replace with ATG Fuse Type Only)

Specifications subject to change without notice

## QUICK START GUIDE



# OPERATION QUICK START GUIDE

EN

A

## GETTING STARTED



### SOURCE MODES



B

## TUNER SETUP

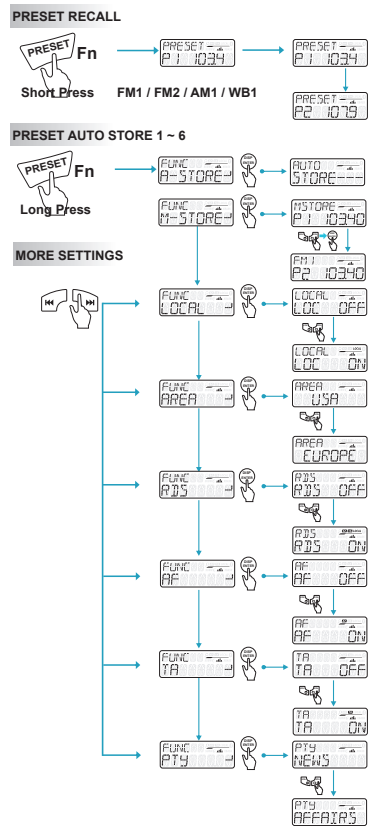

	◆ Short press to mute or restore volume. ◆ Turn the unit on, Press and hold again to turn the unit off. ◆ Press to pause, Press again to resume playback.
	◆ Tuner/Weather Band Mode: Press to enter into the Manual Seek mode, press and hold to enter into the Auto Seek mode. ◆ Media Playback Mode: Press to TrackUp/Down, press and hold for FastForward/Rewind.
SRC	Press to scroll and select available Source.
PRESET Fn	Press to scroll and select Presets 1 ~ 6 Press and hold to enter into the Tuner Function modes: A-STORE / M-STORE / LOCAL / AREA / RDS / AF / TA / PTY
	Press  to decrease the volume, press  to increase the volume.
	◆ Tuner/Weather Band Mode: To change different Band. Press and hold to access into Auto Store mode, the strongest stations of the selected band will be saved in preset channel automatically. FM1, FM2, AM1, WB1 ◆ Media Playback Mode: Press to access into search Folder/File music mode. ◆ Returns to the previous item.
BAND	◆ Tuner Mode: Press to view RDS receiver information. ◆ Media Playback: Press to view ID3 information.
DISP ENTER	◆ Press to access into the Audio Menu mode for adjustments: EQ / XBASS / BASS / MIDDLE / TREBLE / BALANCE / FADER / REAROUT / SUBW / SUBW LPF / SUBW LEVEL ◆ Press and hold to access into the System Menu: BT RECONNECT / BEEP ON/OFF / ABOUT / RESET
AUDIO	
MENU	

All rights reserved. No part of this publication may be reproduced, distributed, or transmitted in any form or by any means, including photocopying, recording, or other electronic or mechanical methods, without the prior written permission of PLANET AUDIO.

C

## AUDIO and SYSTEM SETUP

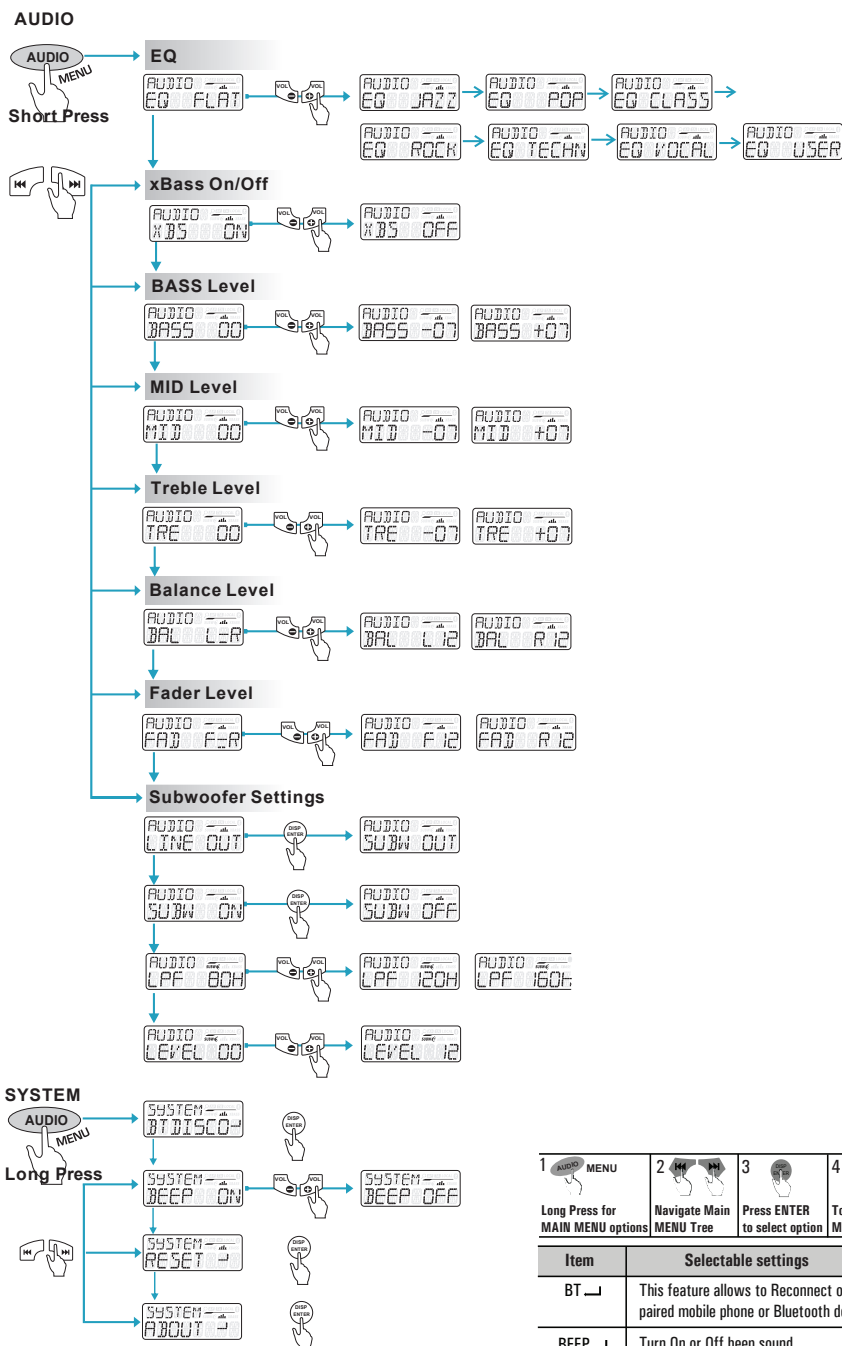

**Tips:** To avoid battery exhaustion be sure to run the vehicles engine while using this product.  
Using this product without running the engine can drain the battery.

D

## RADIO OPERATION

- 1) Press the SRC button to select RADIO
- 2) Press to MUTE, press again to UNMUTE
- 3) To advance stations press
- 4) To skip previous stations press
- 5) Press the button to display RADIO information
- 6) Press the PRESET button to recall PRESETS 1 ~ 6

E

## BLUETOOTH OPERATION

### PAIRING & DISCOVERING A NEW BLUETOOTH CONNECTION

- 1) Power on the PGR35B by pressing and holding down the Power button for 1 second, the Bluetooth ICON will start to flash signalling that the PGR35B is now ready for Bluetooth pairing.

**NOTE:** You have 2 minutes before you must restart this procedure over again.

- 2) Now that the PGR35B is in pairing mode:

#### ANDROID users:

- a. Go into the Settings Menu of your ANDROID device
- b. Enter the Bluetooth Menu and press SCAN
- c. "MARINE RADIO" will now be display under AVAILABLE DEVICES
- d. If prompted, enter passcode: "0000"

#### IOS users:

- a. Go into the Settings Menu of your IOS device
- b. Enter the Bluetooth Menu
- c. "MARINE RADIO" will now be displayed
- d. If prompted, enter passcode: "0000"

- 3) If the PGR35B is not seen, repeat the above steps to refresh the "Device List"
- 4) When the BT connection is successful you will see BT CONNECTED message on the PGR35B LCD display, you are now ready to stream music from your devices favorite media player to the PGR35B

### RECONNECTION

- 1) Power on the PGR35B and your last paired device Bluetooth
- 2) The unit will now automatically be reconnected
- 3) If your device was previously paired with the PGR35B, but it wasn't the last paired device:
  - a. Ensure no other devices are currently paired
  - b. Press and hold MENU button to manually connect / reconnect to the PGR35B
- 4) If the device is out of range from the PGR35B, it will disconnect automatically:
- 5) The PGR35B will reconnect to the device once in range, a confirmation message will be displayed on the LCD

F

## BLUETOOTH STREAMING MUSIC

- 1) Press the SRC button to select BT AUDIO
- 2) Press to start PLAY, press again to PAUSE
- 3) To skip songs or advance tracks press , press and hold to FAST FORWARD
- 4) To select the previous track press the button , press and hold to FAST REWIND
- 5) Press the button to display song ID3 information

G

## USB OPERATION

- 1) Press the SRC button to select USB
- 2) Press to start PLAY, press again to PAUSE
- 3) To skip songs or advance tracks press , press and hold to FAST FORWARD
- 4) To select the previous track press , press and hold to FAST REWIND
- 5) Press the button to display song ID3 information

H

## AUX-INPUT

- 1) Press the SRC button to select AUX IN
- 2) Press to MUTE, press again to UNMUTE



**Tips:** Ensure to adjust the level of your devices master volume to 75%